

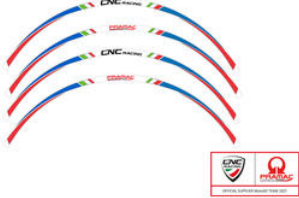





Items for Kawasaki - Ninja 1000 ZX 10R

Code	Item	Picture	Colors	Price
• WK001B	17 inch wheel stripes kit		• Black	€ 21,00
• WK002PR	17 inch wheel stripes kit - pramac Racing Limited Ed.		• Red/Blue	€ 27,00
• PL113B	Adapter to install brake and clutch lever protection.		• Black	€ 18,50
• MR712B	Bar end mirror EVO - left		• Black	€ 85,50
• MR711B	Bar end mirror EVO - right		• Black	€ 85,50

• MR702B Bar end mirror Rocket - left



• Black

€ 71,50

• MR704B Bar end mirror Rocket - left Ø 94.5mm



• Black

€ 85,50

• MR703B Bar end mirror Rocket - right Ø 94.5mm



• Black

€ 85,50

• MR702BS Bar end mirror Rocket left BICOLOR



• Black/Silver

€ 81,50

• MR701B Bar end mirror Rocket right



• Black

€ 71,50

• MR701BS Bar end mirror Rocket right BICOLOR



• Black/Silver

€ 81,50

- SC191B
- SC191G
- SC191R
- SC191L
- SC191O

Bike stand support M8



- Black
- Gold
- Red
- Blue
- Orange

€ 29,50

- LBF19B
- LBF19G
- LBF19R

Brake lever - long folding model



- Black
- Gold
- Red

€ 124,00

- LBF04B
- LBF04G
- LBF04R

Brake lever - long folding model



- Black
- Gold
- Red

€ 124,00

- LBL04B
- LBL04G
- LBL04R

Brake lever - long model



- Black
- Gold
- Red

€ 103,00

- LBL19B
- LBL19G
- LBL19R

Brake lever - long model



- Black
- Gold
- Red

€ 103,00

- LBS19B
- LBS19G
- LBS19R

Brake lever - short model



- Black
- Gold
- Red

€ 103,00

- LBS04B
- LBS04G
- LBS04R

Brake lever - short model



- Black
- Gold
- Red

€ 103,00

- TF446B
- TF446G
- TF446R

**Brake or clutch fluid reservoir cap
M52x4**



- Black
- Gold
- Red

€ 40,50

- TF606B
- TF606G
- TF606R

**Brake or clutch fluid reservoir cap
M52x4 - BICOLOR**



- Black/Silver
- Gold/Silver
- Red/Silver

€ 56,00

- TF886B
- TF886G
- TF886R
- TF886S

**Brake or clutch fluid reservoir cap
M52x4 - Streaks**



- Black
- Gold
- Red
- Silver

€ 40,50

- TF506B
- TF506G
- TF506R
- TF506S

**Brake or clutch fluid reservoir cap
M52x4 - TOUCH**



- Black
- Gold
- Red
- Silver

€ 40,50

- PL150KB
- PL150KG
- PL150KR

**Brake-Guard Carbon Race -
Protection front brake lever glossy
carbon**



- Black
- Gold
- Red

€ 221,50

- **Brake-Guard Carbon Race -**
PL150KBPR **Protection front brake lever glossy**
- **carbon Pramac Racing Limited**
PL150KRPR **Edition**



- Black
 - Red
- € 244,50

- PL150YB **Brake-Guard Carbon Race -**
- PL150YG **Protection front brake lever matt**
- PL150YR **carbon**



- Black
 - Gold
 - Red
- € 221,50

- **Brake-Guard Carbon Race -**
PL150YBPR **Protection front brake lever matt**
- **carbon Pramac Racing Limited**
PL150YRPR **Edition**



- Black
 - Red
- € 244,50

- PL100B **Brake-Guard Race - Protection front**
- PL100G **brake lever**
- PL100R
- PL100S
- PL100L



- Black
 - Gold
 - Red
 - Silver
 - Blue
- € 137,00

- PL100BPR **Brake-Guard Race Pramac Racing**
- PL100RPR **limited edition - Protection front**
brake lever



- Black
 - Red
- € 147,50

- SEA02B **BRAKE/CLUTCH FLUID RESERVOIR**
SOCK COVER



- Black
- € 8,50

- CV015B **Brembo billet CNC and forged brake master cylinder clamp with Mirror Mount thread M10 LH**
- CV015R



- Black
- Red

€ 66,00

- CV016B **Brembo billet CNC and forged brake master cylinder clamp with Mirror Mount thread M8 LH**
- CV016R



- Black
- Red

€ 66,00

- KV428X **BREMBO MASTER CYLINDER CLAMP CNC Racing screw set (2 pcs) - Titanium**



Ti titanium

- Titanium

€ 20,00

- KV427X **Brembo Master Cylinder Clamp CNC Racing screw set (2 pcs) - Titanium**



Ti titanium

- Titanium

€ 20,00

- CV001B **Brembo Master cylinder clamp no Mirror Mount**
- CV001R



- Black
- Red

€ 45,00

- CV011B **Brembo Master cylinder clamp with Mirror Mount thread M10 left**
- CV011R



- Black
- Red

€ 45,00

- CV010B **Brembo Master cylinder clamp with Mirror Mount thread M10 right**
- CV010R



- Black
- Red

€ 45,00

- CV013B **Brembo Master cylinder clamp with Mirror Mount thread M8 left**
- CV013R



- Black
- Red

€ 45,00

- CV012B **Brembo Master cylinder clamp with Mirror Mount thread M8 right**
- CV012R



- Black
- Red

€ 45,00

- SM250B **Clip-ons handlebars Ø50 mm**



- Black

€ 221,50

- SM350B **Clip-ons Ø 50 mm**



- Black

€ 379,00

- LCF45B **Clutch lever - long folding model**
- LCF45G
- LCF45R



- Black
- Gold
- Red

€ 124,00

La sicurezza è il problema principale per il motociclista. Per questo Brembo ha progettato e sviluppato questo prodotto per garantire la massima sicurezza e la massima durata.

- LCF21B
- LCF21G
- LCF21R

Clutch lever - long folding model



- Black
- Gold
- Red

€ 124,00

- LCL21B
- LCL21G
- LCL21R

Clutch lever - long model



- Black
- Gold
- Red

€ 103,00

- LCL45B
- LCL45G
- LCL45R

Clutch lever - long model



- Black
- Gold
- Red

€ 103,00

- LCS21B
- LCS21G
- LCS21R

Clutch lever - short model



- Black
- Gold
- Red

€ 103,00

- LCS45B
- LCS45G
- LCS45R

Clutch lever - short model



- Black
- Gold
- Red

€ 103,00

- 110C74050
- Clutch Master Cylinder Brembo
16RCS CORSA CORTA**



- Black

€ 295,91

- PL250KB **Clutch-Guard Carbon Race -**
- PL250KG **Protection clutch lever glossy**
- PL250KR **carbon**



- Black
- Gold
- Red

€ 221,50

- **Clutch-Guard Carbon Race -**
- PL250KBPR **Protection clutch lever glossy**
- **carbon Pramac Racing Limited**
- PL250KRPR **Edition**



- Black
- Red

€ 244,50

- PL250YB **Clutch-Guard Carbon Race -**
- PL250YG **Protection clutch lever matt carbon**
- PL250YR



- Black
- Gold
- Red

€ 221,50

- **Clutch-Guard Carbon Race -**
- PL250YBPR **Protection clutch lever matt carbon**
- **Pramac Racing Limited Edition**
- PL250YRPR



- Black
- Red

€ 244,50

- PL200B **Clutch-Guard Race - Clutch lever**
- PL200G **protection**
- PL200R
- PL200S
- PL200L



- Black
- Gold
- Red
- Silver
- Blue

€ 137,00

- PL200BPR **Clutch-Guard Race - Clutch lever**
- PL200RPR **protection PRAMAC RACING Lim.**
- Ed.**



- Black
- Red

€ 147,50

• Patch **Embroidered patch** • White € 5,50



• GA005B **FAIRING RIVET PUSH PIN KIT - 80PCS NYLON** • Black € 36,50



• SE700BPR **Fluid oil reservoir brake-clutch 12 ml**
• SE700RPR **MONOCHROME** included three outflow **PRAMAC RACING Limited Edition**



• SE701BPR **Fluid oil reservoir brake-clutch 25 ml**
• SE701RPR **MONOCHROME** included three outflow **PRAMAC RACING Limited Edition**



• TF508B **Fluid reservoir cap brake / clutch**
• TF508G **M37x4 - TOUCH**
• TF508R
• TF508S



• TF608B **Fluid reservoir cap brake/clutch**
• TF608G **M37x4 - BICOLOR**
• TF608R



- SE801K **Fluid reservoir front brake 25 ml - carbon**
- SE801Y



- Glossy
- Matt

€ 149,50

- SE801KPR **Fluid reservoir front brake 25 ml**
- SE801YPR **Pramac Racing Limited Edition - carbon**



- Glossy
- Matt

€ 169,00

- SE501B **Fluid reservoir front brake 25 ml REBEL**
- SE501G
- SE501R
- SE501S
- SE501L



- Black
- Gold
- Red
- Silver
- Blue

€ 113,00

- SE501BPR **Fluid reservoir front brake 25 ml**
- SE501RPR **REBEL - Pramac racing Limited Edition**



- Black
- Red

€ 131,50

- SEB25B **Fluid reservoir front brake 25 ml with level window - only body**
- SEB25G
- SEB25R
- SEB25L



- Black
- Gold
- Red
- Blue

€ 75,00

- SEC25B **Fluid reservoir front brake 25 ml with level window - only cap**
- SEC25G
- SEC25R
- SEC25L



- Black
- Gold
- Red
- Blue

€ 23,00

- SE800K **Fluid reservoir rear brake / clutch 12 ml - carbon**
- SE800Y



- Glossy
- Matt

€ 143,50

- SE800KPR **Fluid reservoir rear brake / clutch 12 ml Pramac Racing Limited Edition - Carbon**
- SE800YPR



- Glossy
- Matt

€ 164,00

- SE500B **Fluid reservoir rear brake / clutch 12 ml REBEL**
- SE500G
- SE500R
- SE500S
- SE500L



- Black
- Gold
- Red
- Silver
- Blue

€ 113,00

- SE500BPR **Fluid reservoir rear brake / clutch 12 ml REBEL - Pramac Racing Limited Edition**
- SE500RPR



- Black
- Red

€ 131,50

- SEB12B **Fluid reservoir rear brake / clutch 12 ml with level window - only body**
- SEB12G
- SEB12R
- SEB12S
- SEB12L



- Black
- Gold
- Red
- Silver
- Blue

€ 69,00

- SEC12B **Fluid reservoir rear brake / clutch 12 ml with level window - only cap**
- SEC12G
- SEC12R
- SEC12L



- Black
- Gold
- Red
- Blue

€ 23,00

- IFA01B **Fluid tank mounting kit for Brembo**
- IFA01G **RCS**
- IFA01R



- Black
- Gold
- Red

€ 32,50

- RE374B **Fork spring preload adjuster**
- RE374G
- RE374R
- RE374L



- Black
- Gold
- Red
- Blue

€ 40,50

- TF448B **Front brake or clutch fluid reservoir cap M37x4**



- Black

€ 40,50

- TF888B **Front brake or clutch fluid reservoir cap M37x4 - Streaks**
- TF888G
- TF888R
- TF888S



- Black
- Gold
- Red
- Silver

€ 40,50

- GA001W **FUEL JUG 5LT**



- White

€ 25,00

- GA016B **Garage carpet**



- Black

€ 124,00

• GA003B GARAGE CARPET

• Black

€ 124,00



• GA003BPR GARAGE CARPET PRAMAC RACING LIMITED EDITION

• Black

€ 126,00



• ZA701K GP DUCTS - Front brake cooling system

• ZA701Y

• Glossy
• Matt

€ 241,50



• ZA701KPR GP DUCTS - Front brake cooling system Pramac Racing Lim. Ed.

• ZA701YPR

• Glossy
• Matt

€ 262,00



• ZAB08B GP DUCTS - mounting kit

• Black

€ 45,00

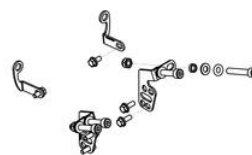

• MPR01B Grips - rubber replacement

• Black

€ 19,00



- MP105B **Grips EVO**
- MP105G
- MP105R



- Black
- Gold
- Red

€ 61,50

- MP105BG **Grips EVO - Bicolor**
- MP105BR



- Black/Gold
- Black/Red

€ 77,50

- MP100B **Grips Lab One**
- MP100G
- MP100R
- MP100S
- MP100L



- Black
- Gold
- Red
- Silver
- Blue

€ 57,50

- PL002B **Handlebar cap Blaze - only left side**
- PL002G
- PL002R



- Black
- Gold
- Red

€ 24,00

- PL001BPR **Handlebar cap left side Pramac**
- PL001RPR **Racing limited Edition**



- Black
- Red

€ 29,50

- PL001B **Handlebar cap single side**
- PL001G
- PL001R
- PL001S
- PL001L



- Black
- Gold
- Red
- Silver
- Blue

€ 24,00

• PL003R **Handlebar cap single side Tricolore** • Red € 30,00



• CM242L **Handlebar ends "Stars and Stripes"** • Blue € 59,00



• CM231B **Handlebar ends BI-COLOR** • Black € 56,00
• CM231G • Gold
• CM231R • Red



• CM239B **Handlebar ends BLAZE** • Black € 39,50
• CM239G • Gold
• CM239R • Red



• CM230B **Handlebar ends BOING** • Black € 45,00
• CM230G • Gold
• CM230R • Red



• CM233B **Handlebar ends Extralight** • Black € 33,50
• CM233G • Gold
• CM233R • Red
• CM233L • Blue



- CM238B **Handlebar ends GEAR**
- CM238R
- CM238S



- Black
- Red
- Silver

€ 64,00

- CM238BS **Handlebar ends GEAR bicolor**



- Black/Silver

€ 68,00

- CM236B **Handlebar ends LOOK**
- CM236G
- CM236R
- CM236S
- CM236L



- Black
- Gold
- Red
- Silver
- Blue

€ 45,00

- **Handlebar ends LOOK Pramac**
- CM236BPR **Racing Limited Edition**
-
- CM236RPR



- Black
- Red

€ 51,50

- CM234B **Handlebar ends MINI**
- CM234G
- CM234R



- Black
- Gold
- Red

€ 29,50

- CM431SR **Handlebar ends Stainless Steel BI-**
- CM431SB **COLOR**
- CM431SG



- Silver/Red
- Silver/Black
- Silver/Gold

€ 99,00

• CM241R **Handlebar ends Tricolore**

• Red

€ 59,00



• GA008B **HANDLEBAR STRAP KIT**

• Black

€ 4,50



• KR001N **Keyring**

• White

€ 2,50



• RS010B **Led indicators Resistor Kit**

• Black

€ 13,50



• IFL03B **Lever final part for Brembo RCS and**
• IFL03G **RCS CorsaCorta**
• IFL03R

• Black
• Gold
• Red

€ 110,00



• IFL01B **Lever final part short for Brembo**
• IFL01G **brake master cylinder CNC - XR**
• IFL01R **Models**

• Black
• Gold
• Red

€ 110,00



- IFL02B
- IFL02G
- IFL02R

Lever final part short for Brembo RCS and RCS CorsaCorta

- Black
- Gold
- Red

€ 110,00



- PLM02B
- PLM02R

Lever-Guard Street - Clutch lever protector with bar-end mirror housing

- Black
- Red

€ 98,00



- PLM02BPR
- PLM02RPR

Lever-Guard Street - Clutch lever protector with bar-end mirror housing - Pramac racing Limited Edition

- Black
- Red

€ 113,50



- PLM01B
- PLM01R

Lever-Guard Street - Protection front brake lever with bar-end mirror housing

- Black
- Red

€ 98,00



- PLM01BPR
- PLM01RPR

Lever-Guard Street - Protection front brake lever with bar-end mirror housing - Pramac Racing Limited Edition

- Black
- Red

€ 113,50



- ID014B

License plate led light "FIRE"

- Black

€ 21,00



• ID013B License plate led light "UFIX" • Black € 31,00



• ID025B License plate light led PRO - aluminum • Black € 29,00



• MRA02B M8 Screw Adapter for bar-end mirror Rocket - LHS • Black € 15,00



• MRA01B M8 Screw Adapter for bar-end mirror Rocket - RHS • Black € 15,00



• GA006R MEDIUM STRENGHT THREADLOCKER 10 ml • Red € 13,50



• MRA12B Mirror Blanking Plug M10 - Thread
• MRA12G LH
• MRA12R
• MRA12S • Black
• Gold
• Red
• Silver € 12,50



• MRA11B **Mirror Blanking Plug M10 - Thread**
• MRA11G **RH**
• MRA11R
• MRA11S



• Black
• Gold
• Red
• Silver

€ 12,50

• MRA14B **Mirror Blanking Plug M8 - Thread LH**
• MRA14G
• MRA14R



• Black
• Gold
• Red

€ 12,50

• MRA13B **Mirror Blanking Plug M8 - Thread RH**
• MRA13G
• MRA13R
• MRA13S



• Black
• Gold
• Red
• Silver

€ 12,50

• GA007B **MOTORCYCLE TIE DOWN RATCHET STRAP KIT**



• Black

€ 28,00

• GA015N **MOTUL Brake fluid DOT 5.1 - 500 ml**



• Natural

€ 13,50

• MUG01W **Mug 11oz**



• White

€ 8,50

• MUG02PR **MUG 11oz Pramac Racing**

• White

€ 21,00



• DA387B **Nuts ring gear M10x1.25**
• DA387G
• DA387R

• Black
• Gold
• Red

€ 41,50



• DA387X **Nuts ring gear M10x1.25 - Titanium**

• Titanium

€ 158,00



• GA002E **OIL DRAIN CAN 6LT**

• Green

€ 40,50



• GA004B **OIL DRAIN PAN 8LT**

• Black

€ 21,00



• TA141B **Oil filler cap Exagon M30x1,5**
• TA141G
• TA141R
• TA141L

• Black
• Gold
• Red
• Blue

€ 24,00



• 110C74040 Radial Brake Master Cylinder
Brembo 17 RCS Corsa Corta



• Black

€ 295,91

• 110A26340 RADIAL BRAKE MASTER
CYLINDER BREMBO 17RCS FOLD-
UP LEVER 18-20 RATIO



• Black

€ 220,91

• 110C74010 RADIAL BRAKE MASTER
CYLINDER BREMBO 19RCS CORSA
CORTA FOLD-UP LEVER 18-20
RATIO



• Black

€ 295,91

• 110A26310 RADIAL BRAKE MASTER
CYLINDER BREMBO 19RCS FOLD-
UP LEVER 18-20 RATIO



• Black

€ 220,91

• 110A26350 Radial Clutch Master Cylinder
Brembo 16RCS



• Black

€ 241,90

• KV323B Rear mudguard screws kit
• KV323G
• KV323R



• Black

• Gold

• Red

€ 29,00

• PT015B **Reflector**

• Black

€ 5,50



• PT010B **Reflector kit with bracket**

• Black

€ 16,50



• RJ003B **Remote Adjuster - front brake lever**
• RJ003R **Brembo Billet CNC and Forged**

• Black
• Black/Red

€ 127,00



• RJ001B **Remote Adjuster - front brake lever**
• RJ001R **Brembo OEM**

• Black
• Black/Red

€ 127,00



• RJ002B **Remote Adjuster - front brake lever**
• RJ002R **Brembo RCS**

• Black
• Black/Red

€ 127,00



• RJ004B **Remote Adjuster - front brake lever**
• RJ004R **Race**

• Black
• Black/Red

€ 127,00



- KV320B **Screws kit Front Mudguard**
- KV320G
- KV320R



- Black
 - Gold
 - Red
- € 37,50

-
- STK01B **Stickers kit**



- Black
- € 9,50

-
- GA011K **Tool tray - Carbon matt**
 - GA011Y



- Glossy
 - Matt
- € 185,50

-
- GA011KPR **Tool tray - Carbon matt - Pramac**
 - GA011YPR **Racing Limited Edition**



- Glossy
 - Matt
- € 205,00

-
- ID017B **Turn indicator FAST Led**



- Black
- € 63,00

-
- ID015B **Turn indicator JET LED Approved**



- Black
- € 51,50
-

• ID021B	Turn indicator Led DOT		• Black	€ 77,50
• ID020B	Turn indicator Led Sequential FLOW		• Black	€ 81,50
• ID016B	Turn indicator SKY led		• Black	€ 51,50
• ID018B	Turn indicator Task + front position light Led		• Black	€ 63,00
• ID019B	Turn indicator Task + rear position and stop light Led Approved		• Black	€ 63,00
• IDA80B	Turn Indicators Cover Sleeves M8 - 2 pcs		• Black	€ 5,50

- KS250B
- KS250G
- KS250R
- KS250L

Universal billet bleed valve cover kit for Brembo



- Black
- Gold
- Red
- Blue

€ 35,00

- CE710N

Universal power shifter



- Natural

€ 541,00

- KS252B
- KS252G
- KS252R
- KS252O

Wheel valve cap kit



- Black
- Gold
- Red
- Orange

€ 12,50

- KV325B
- KV325G
- KV325R

Windscreen screws Kawasaki ZX-10R



- Black
- Gold
- Red

€ 57,00